

4X3 Vandal Resistant Keypad Type SUZKP-168-MA12 Tactile

Publication Number: KP011/0212

Application

The flush fitting MA12 Keypad combines robust vandal resistance with an attractive design to meet the most demanding of today's concepts and specifications, in a wide range of applications from public services to specialist use in heavy duty environments and adverse weather conditions. The MA12 complements the matching 3 x 4 MA10 and 4 x 4 MA11 keypads.

Operation

The MA12 keys have a positive 'click' feel and operate a matrix connected Poly/Metal dome membrane switch unit (other terminations are available). See overleaf for connector pin out details.

Construction

The 4 keys are fitted in a 2.0mm stainless steel faceplate bolted to a polycarbonate body housing the membrane switch unit. The stainless steel keys and faceplate have a horizontally finished finish. The design of the MA12 ensures that the membrane is protected from direct shock loads.

The individual keys are sealed and water resistant. An optional gasket is available to seal the MA12 to the clients structure. The MA12 mounting flange will accommodate panel thicknesses up to 6.35 max.

An industry standard 2.54mm pitch female 5 way connector is provided to interface with client equipment. Connection of the faceplate to earth is made by one of the weld studs.

The shallow depth MA12 Keypad can be supplied loose or incorporated into a stainless steel panel with a finished finish and etched and painted legends. For aperture and weld stud details ask for our drawing (as below).

Product Features

Panel Material:

- SUS304.

Key pad:

- 16 seal membrane keypads included 0 to 9 and "Cancel", "Correct", "Enter" function keys.
- 5000,000 times life cycle

Communication:

- RS-232C interface with 9-Pin Female D-type connector.
- Programmable baud rate from 9600 to 115200

Security Features:(OPTION)

- Battery backup key storage to save 1500sets above of masterkey/workingkeys (4 key sectors).
- Each key sector can save up to 250 working keys.
- Completely sealed housing
- Microswitch detects tampering
- Imbedded functions supported ANSI X9.8 PIN block format and ANSI X9.9 Message Authentication Code

Power Supply:

- +5VDC, 90mA from USB/PS/2 /RS232 keyboard port

Physical Characteristics:

- Temperature range : 0°C to 90°C.
- Weight : 700 g~

Operating System Support:

- Microsoft Windows 95/98/NT/2000/XP, Linux, ANDROID
- Application Program Interface in C, C++ and Visual Basic, WORSA/XFS

■ Technical Detail *Mechanical*

Key movement:	1.0mm nominal	
Key operating pressure:	4N nominal	
Keypad weight:	180 grammes	
Environmental protection from front:	IP66 and IP68	
Number of operations:	10 ⁶ nominal	
Working and storage temperature:	-22°C + 60°C, RH 90% non condensing	
Panel aperture dimensions:	height	87.1mm
	width	36.5mm
	corner radius	4mm
	height	101.2mm
Overall keypad dimensions:	width	39.9mm
	depth	9.0mm

Body mouldings in high grade polycarbonate with a fire rating of V0 to UL94

Membrane Electrical Specification

Membrane contact rating:	0.1 ma - 50 ma
Voltage:	1.5V d.c. minimum - 30V d.c. maximum (resistive, smooth supply)
Contact resistance:	less than 45 ohm
Switch power:	0.5 watt maximum
Contact bounce:	20 ms maximum
Dielectric strength:	100V rms for 1 minute
Insulation resistance:	10M ohm at 40°C, 93% r.h.
Contact material:	silver conductive ink

Markings

Keys may be supplied blank or with legends specified by customer. There may be an artwork charge for special legends not available from our library.

EMC Note

This item is considered to be a component and therefore does not have to comply with the EMC Directive.

DIRECTION OF GRAIN IN FINISHED STAINLESS STEEL FACEPLATE AND KEYS

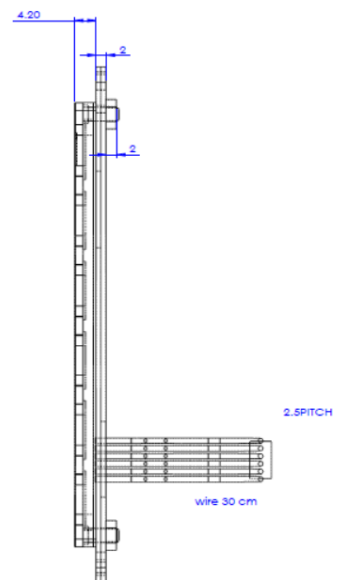
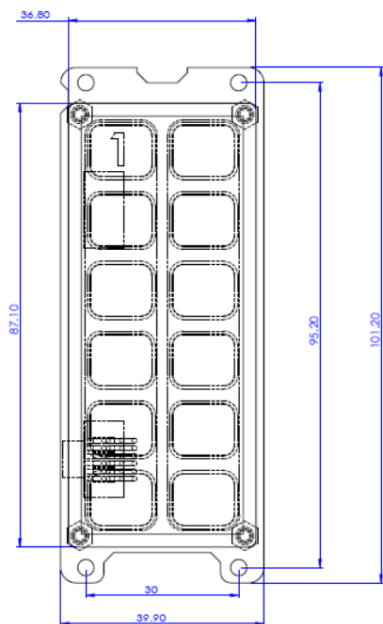
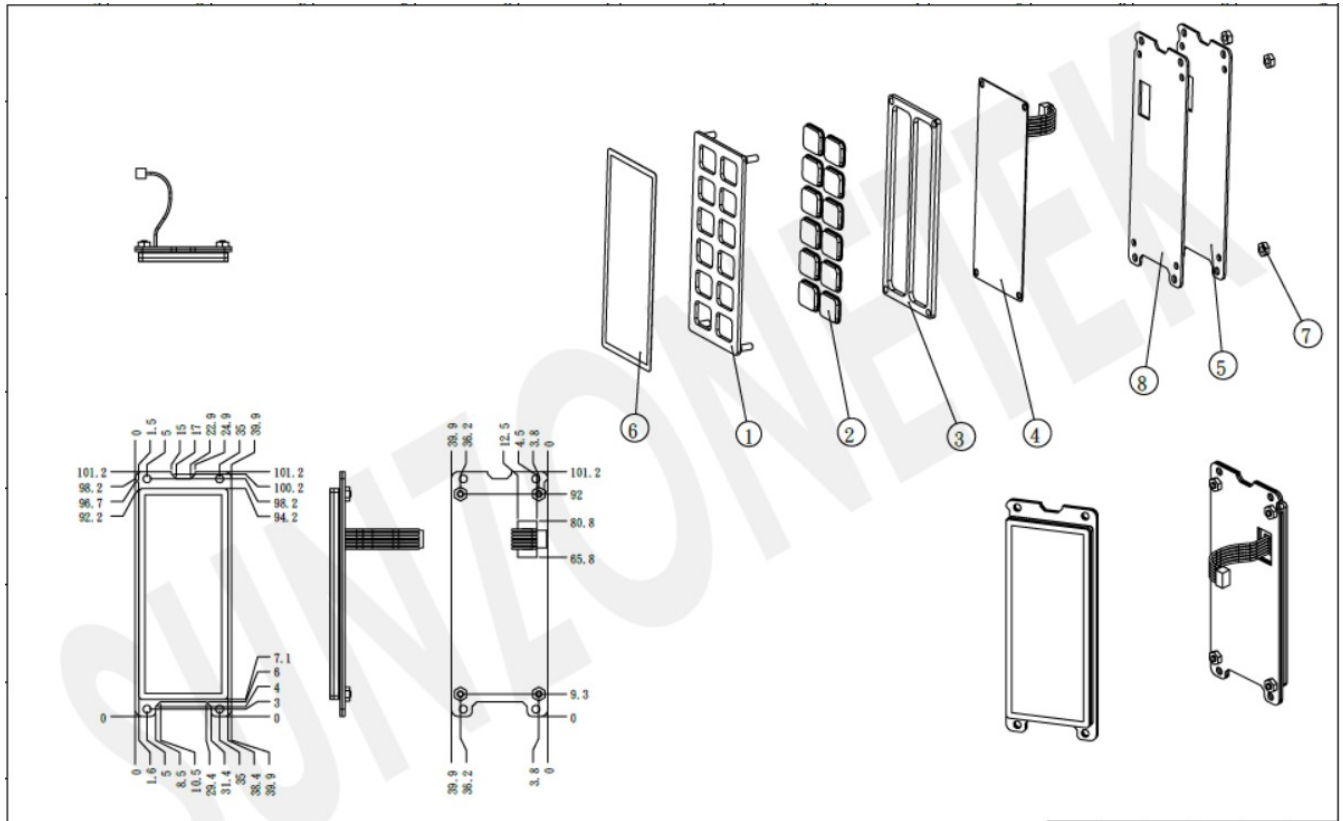

Customized layout

Layout NUMBER

1	2	3	4	5	OK
6	7	8	9	0	<